

SMOKELESS GRILL ELITE™

STEP 1



Disassemble and remove all packaging materials.

STEP 2



Reassemble in the same order they were packaged (see reverse side for detailed instructions).

STEP 3



Ensure that the Water Tray is in place and fill with about 2 cups of water.

STEP 4



Attach the Power Cord to the Base Unit and then plug the Power Cord into an outlet.

STEP 5



Press the Power Button and then the Fan Button. Set the temperature to a medium or high heat setting for 4–6 mins. to preheat the grill. Then, set the desired cooking temperature and add your food.

Quick Start Guide

See owner's manual for complete instructions and important safety information before using this product.

IMPORTANT: Unpack all parts from the box and remove any clear or blue protective film on the components. Wash with warm, soapy water before first use (only select accessories are dishwasher safe).

Assembly

SAVE THESE INSTRUCTIONS

SMOKELESS GRILL ELITE™

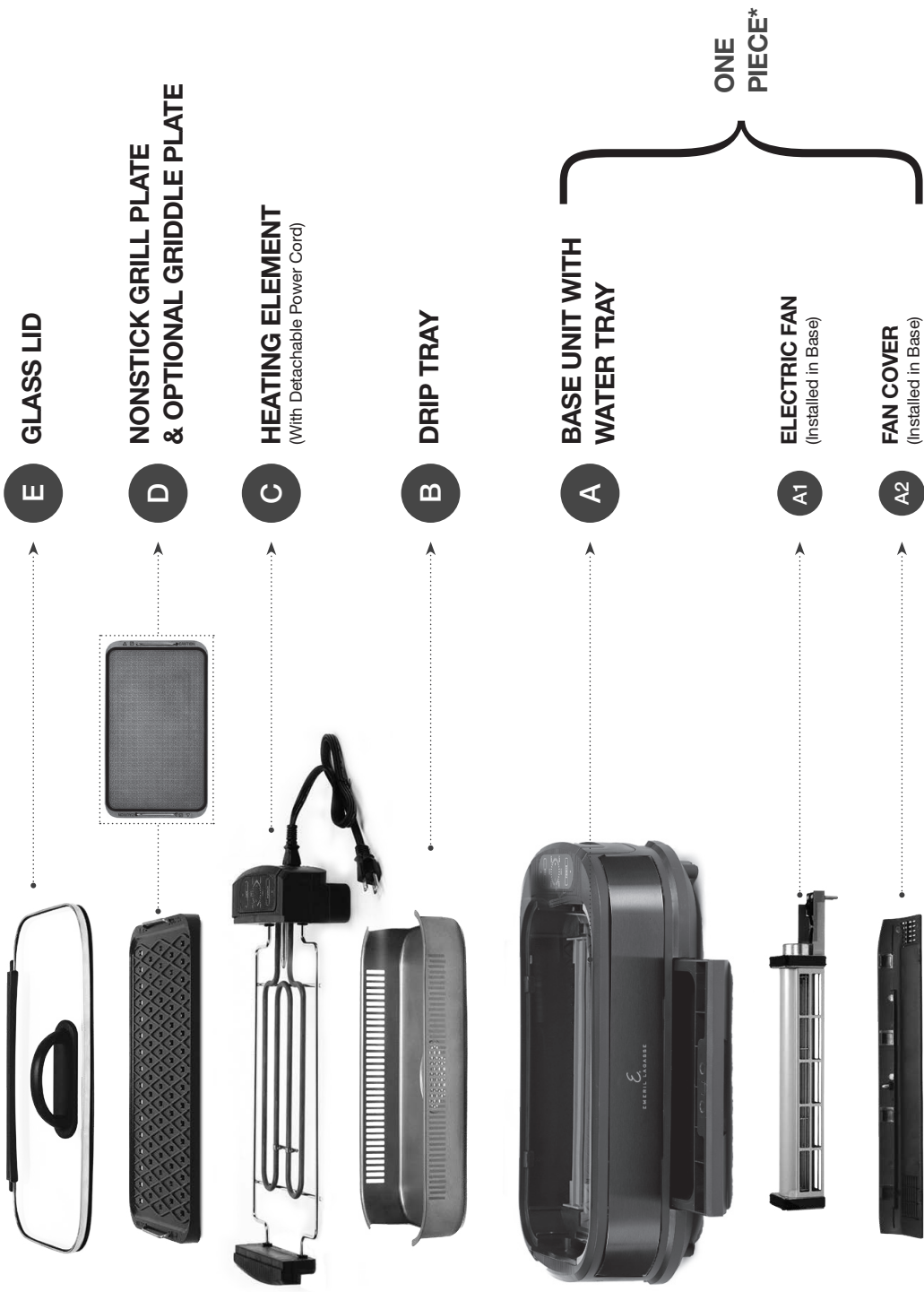

1. Place the Base Unit (A) on a stable, level surface.
2. Place the Drip Tray (B) inside the center of the Base Unit (A).
3. Place the Heating Element (C) on top of the Drip Tray (B). Align the arrows on the Drip Tray (B) with the arrows on the Base Unit (A).
4. Place either the Grill Plate or Griddle Plate (D) on top of the Heating Element (C).
5. When cooking with the Glass Lid (E), place the Glass Lid (E) over the Grill Plate or Griddle Plate (D).

***NOTE:** The removable Electric Fan (A1), Fan Cover (A2), and Collection Pan/Water Tray are already installed in the Base Unit (A). If you are thoroughly cleaning the Base Unit (A) with water and detergent, remove the Electric Fan (A1) first. See **Removing the Electric Fan** in the owner's manual for detailed instructions.